

| REVISIONS | | | |
|-----------|-----------------|------------|----------|
| REV | DESCRIPTION | DATE | APPROVED |
| A | INITIAL RELEASE | 05/22/2019 | NFR |

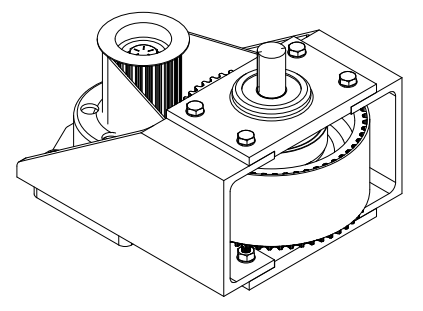
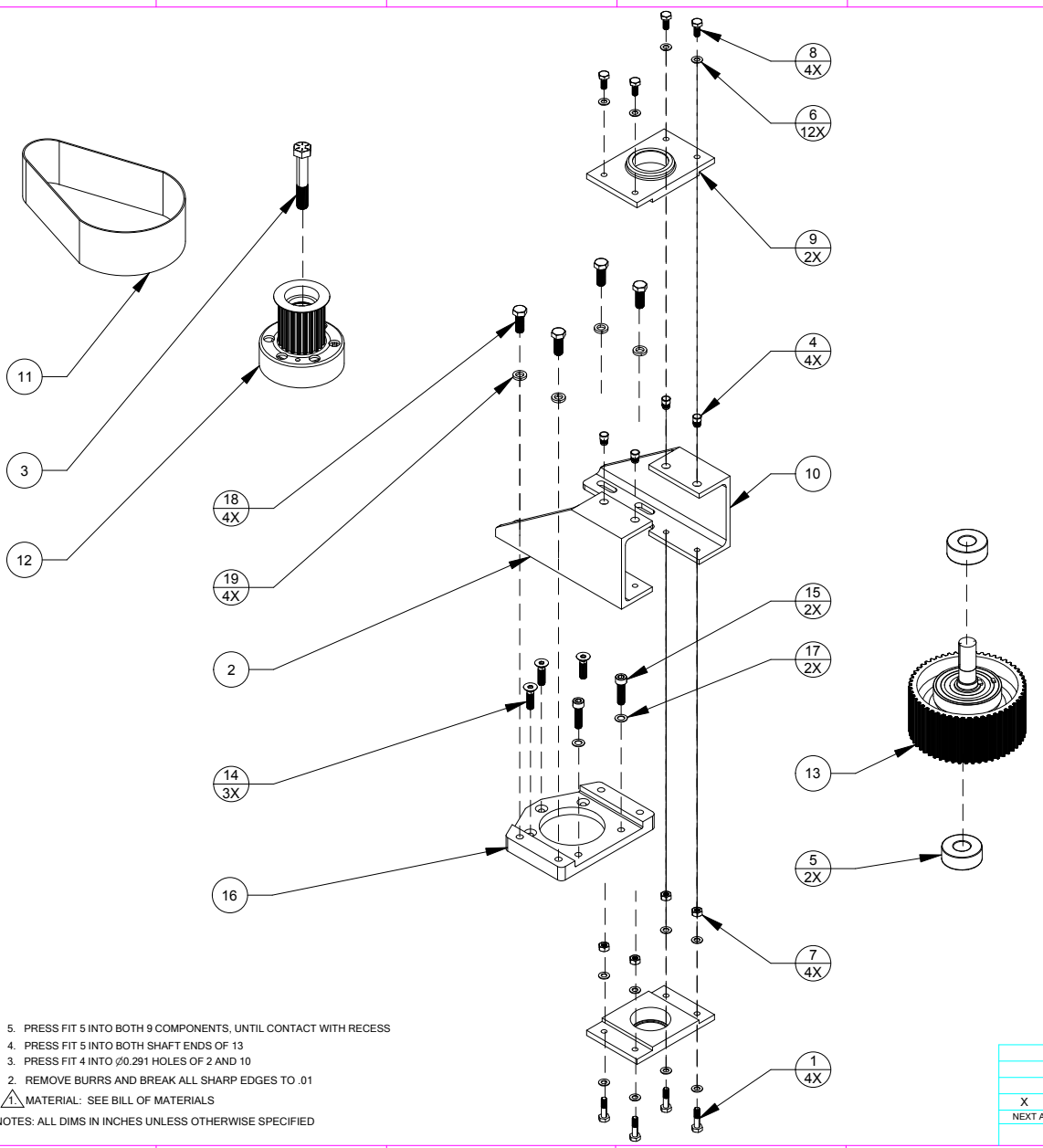

| QTY | DESCRIPTION | PART NO. OR IDENTIFYING NO. | SPECIFICATION | MATERIAL OR NOTES | ITEM NO. |
|-----|-----------------------------------|-----------------------------|---------------|-------------------|----------|
| 4 | WASHER, AN960-616L | 31136 | | | 19 |
| 4 | STUD, 3/8 X 24 X 1 | 31086 | | | 18 |
| 2 | WASHER, AN960-516L | 31066 | | | 17 |
| 1 | MOUNT, REDUCTION MZ202 | 30615 | | | 16 |
| 2 | SCREW, SHCS M8 X 30 YELLOW ZINC | 30722 | | | 15 |
| 3 | SCREW, FHCS M8 X 30 YELLOW ZINC | 30725 | | | 14 |
| 1 | ASSEMBLY, XE SPROCKET #2 | 30605 | | | 13 |
| 1 | ASSEMBLY, CLUTCH MZ202 | 30810 | | | 12 |
| 1 | BELT, COG PRIMARY XE | 60012 | | | 11 |
| 1 | PRIMARY REDUCTION HOUSING - RIGHT | 30590 | | | 10 |
| 2 | MOUNT, PRIMARY REDUCTION BEARING | 30600 | | | 9 |
| 4 | BOLT, AN4-5A | 31003 | | | 8 |
| 4 | NUT, AN365-428A | 31058 | | | 7 |
| 12 | WASHER, AN960-416L | 31065 | | | 6 |
| 2 | BEARING, SPROCKET #2 SHAFT | 52204 | | | 5 |
| 4 | NUTSERT, 1/4-28 | 31013 | | | 4 |
| 1 | SCREW, HHCS, 1/2-20 3 GRADE 8 | 31087 | | | 3 |
| 1 | PRIMARY REDUCTION HOUSING - LEFT | 30595 | | | 2 |
| 4 | BOLT, AN4-10A | 31004 | | | 1 |

| CITY | | NOMENCLATURE OR DESCRIPTION | | PART NO. OR IDENTIFYING NO. | | SPECIFICATION | | MATERIAL OR NOTES | | ITEM NO. | |
|---|--|-----------------------------|--|-----------------------------|--|--------------------|--|-------------------|--|-----------------|--|
| PARTS LIST | | | | | | | | | | | |
| THIS DRAWING AND THE INFORMATION THEREON IS THE PROPERTY OF THE COMPOSITE FX COMPANY AND IS CONSIDERED PROPRIETARY AND CONFIDENTIAL TO THE COMPOSITE FX COMPANY. REPRODUCTION OR DISCLOSURE OF ANY PART OF THIS DRAWING OR INFORMATION THEREON AND THE USE THEREOF FOR MAKING OTHER DRAWINGS OR FOR MAKING APPARATUS THEREFROM ARE PROHIBITED WITHOUT PRIOR SPECIFIC WRITTEN CONSENT OF COMPOSITE FX. | | | | | | | | | | | |
| DRAWN BY | | W CONVILLE 05/22/19 | | DATE | | N RICHTER 05/22/19 | | CHECKED DATE | | APPROVED DATE | |
| NEXT ASSY | | X | | USED ON | | X | | APPLICATION | | X | |
| UNLESS OTHERWISE SPECIFIED DIMENSIONS ARE IN INCHES | | TOLERANCES ON FRACTIONS | | DECIMALS | | ANGLES | | SIZE | | CODE IDENT. NO. | |
| +/- | | .XX +/- 0.05 | | .XX +/- 0.05 | | +/- .5° | | D | | 30092 | |
| SCALE NONE | | WT. ACT. | | SHEET 1 OF 1 | | REV | | A | | REV | |

- 5. PRESS FIT 5 INTO BOTH 9 COMPONENTS, UNTIL CONTACT WITH RECESS
- 4. PRESS FIT 5 INTO BOTH SHAFT ENDS OF 13
- 3. PRESS FIT 4 INTO $\phi 0.291$ HOLES OF 2 AND 10
- 2. REMOVE BURRS AND BREAK ALL SHARP EDGES TO .01
- △ MATERIAL: SEE BILL OF MATERIALS
- NOTES: ALL DIMS IN INCHES UNLESS OTHERWISE SPECIFIED